

REVISIONS		
4-13-2007	CRAIG F. REMINGTON	23924

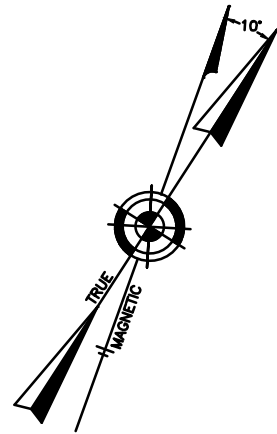

VENTNOR AVENUE
(COUNTY ROUTE NO. 629)
(80' R.O.W.)

PLAN
SCALE: 1"=50'

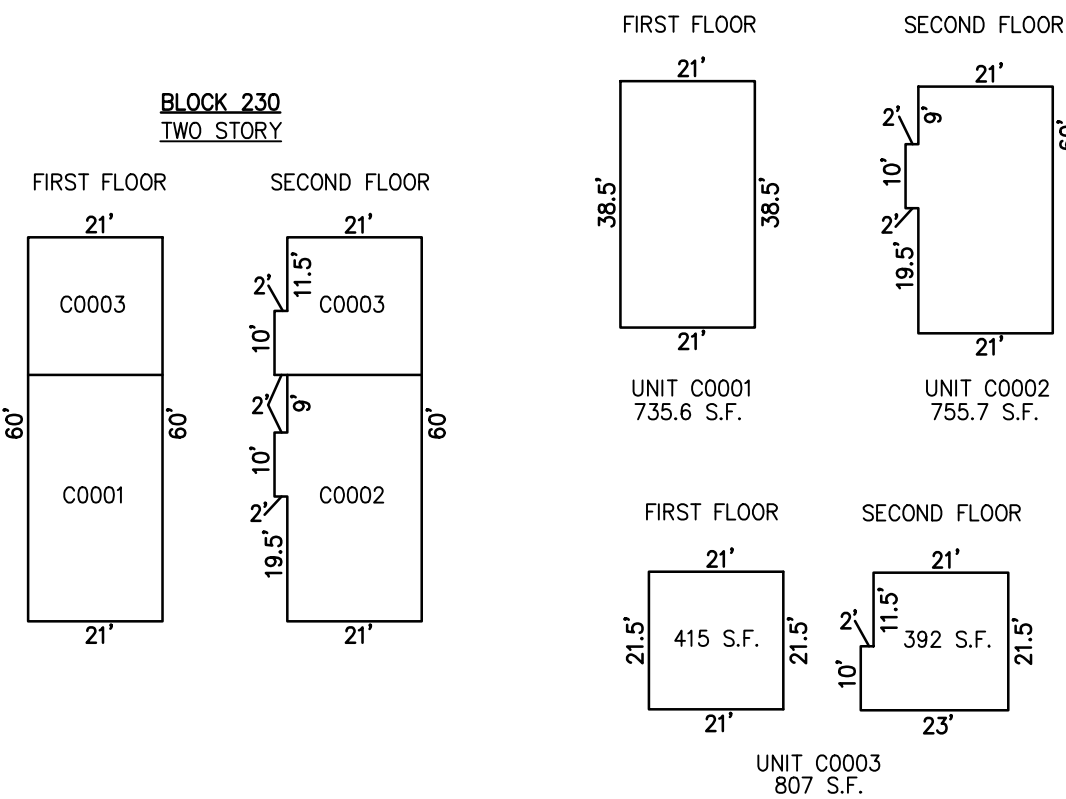

DETAILS
SCALE: 1"=30'

BLOCK 230, LOT 40
9605 VENTNOR AVENUE CONDOMINIUM
9605 VENTNOR AVENUE
INSET "2C"

UNIT NO.	LOT NO.
C0001	C-01
C0002	C-02
C0003	C-03

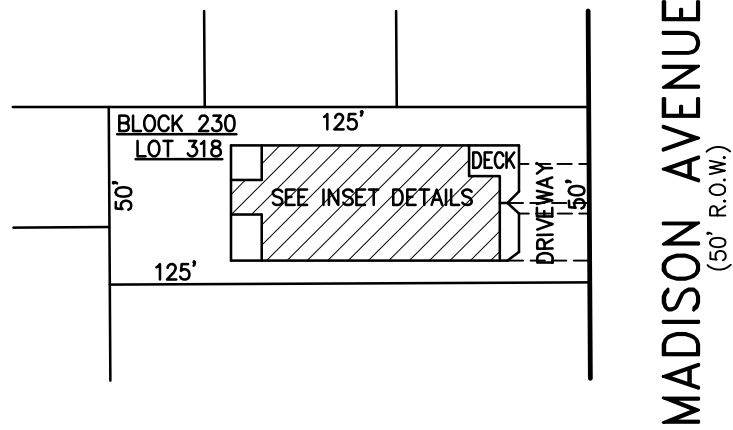
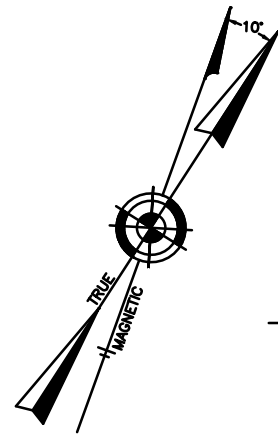

PLAN
SCALE: 1"=50'

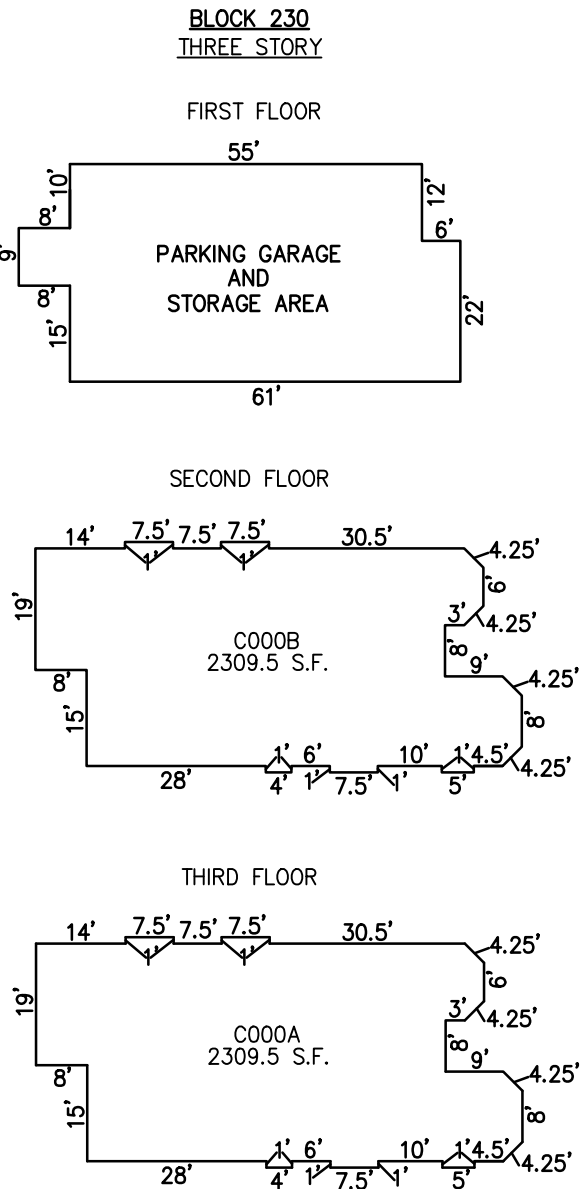

DETAILS
SCALE: 1"=30'

BLOCK 230, LOT 318
20 NORTH MADISON AVENUE CONDOMINIUM
20 NORTH MADISON AVENUE
INSET "2D"

UNIT NO.	LOT NO.
C-000A	C-01
C-000B	C-02

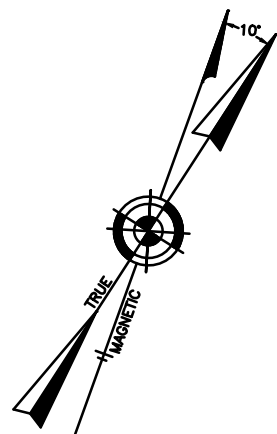

COOLIDGE AVENUE
(50' R.O.W.)

VENTNOR AVENUE (COUNTY ROUTE NO. 629)
(80' R.O.W.)

PLAN
SCALE: 1"=50'

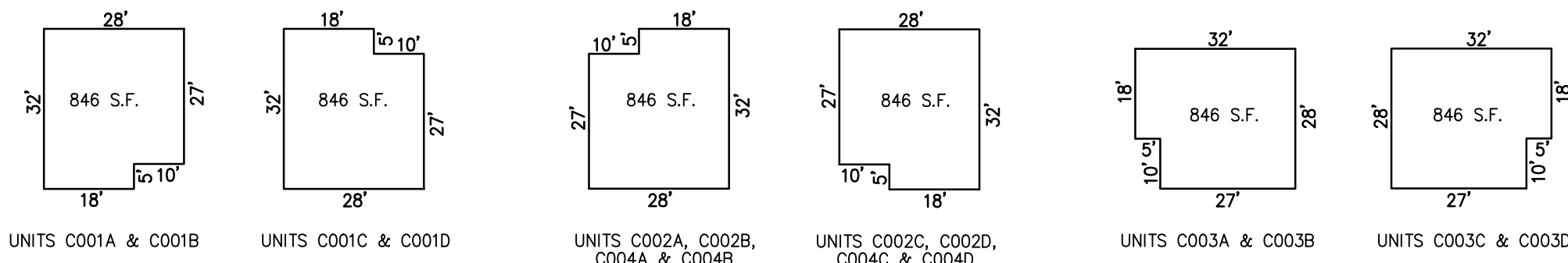

DETAILS
SCALE: 1"=30'

BLOCK 231, LOT 6
ROYAL PALM CONDOMINIUM
971 VENTNOR AVENUE
INSET "2E"

UNIT NO.	LOT NO.
C001A	C-1.01
C001B	C-1.02
C001C	C-1.03
C001D	C-1.04
C002A	C-2.01
C002B	C-2.02
C002C	C-2.03
C002D	C-2.04
C003A	C-3.01
C003B	C-3.02
C003C	C-3.03
C003D	C-3.04
C004A	C-4.01
C004B	C-4.02
C004C	C-4.03
C004D	C-4.04

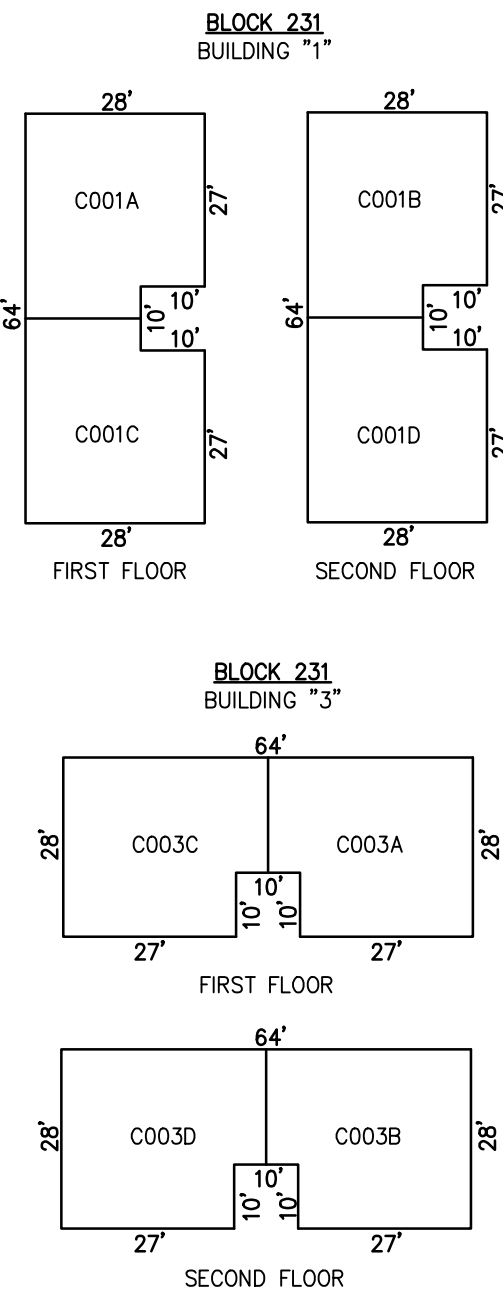

DETAILS
SCALE: 1"=30'

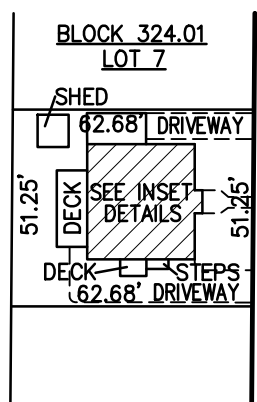
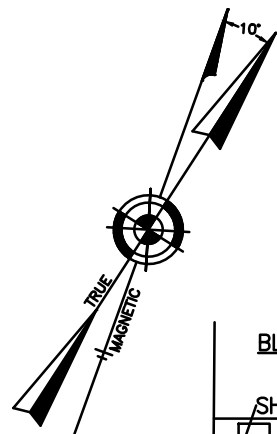
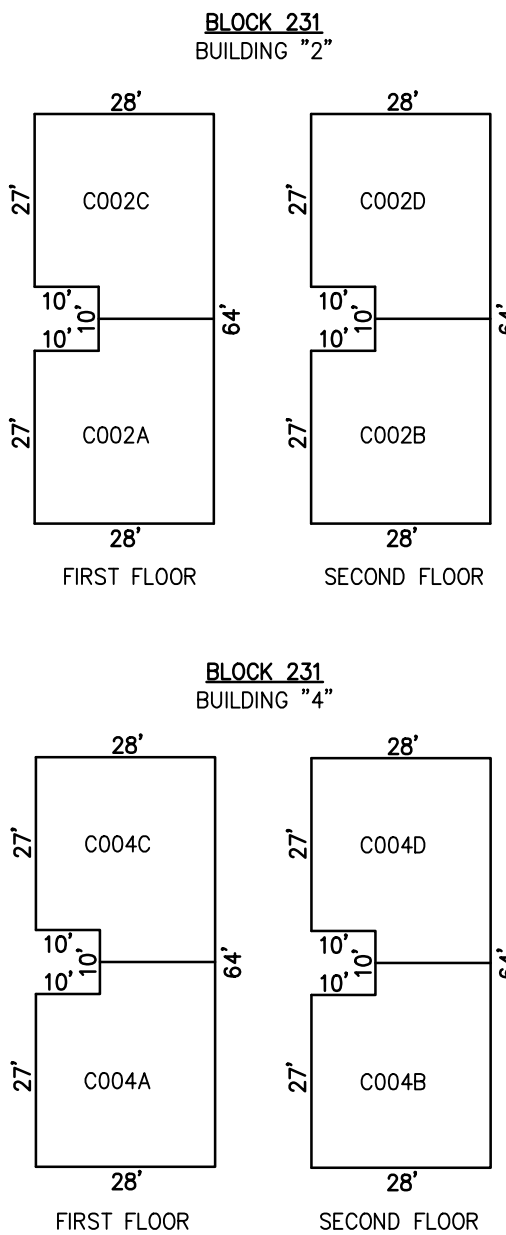

PLAN
SCALE: 1"=50'

BLOCK 324.01, LOT 7
106 NORTH HARDING AVENUE CONDOMINIUM
106 NORTH HARDING AVENUE
INSET "2F"

DETAILS
SCALE: 1"=30'

UNIT NO.	LOT NO.
C-000A	C-01
C-000B	C-02

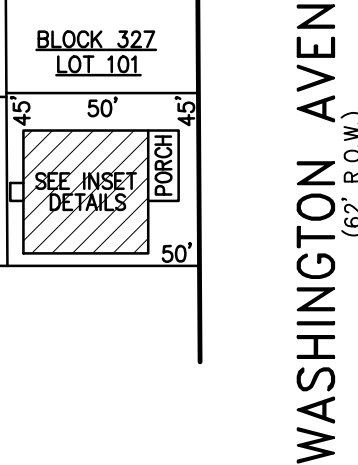
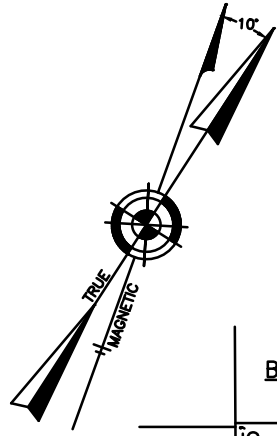

PLAN
SCALE: 1"=50'

BLOCK 327, LOT 101
126 NORTH WASHINGTON CONDOMINIUM
126 NORTH WASHINGTON AVENUE
INSET "2G"

DETAILS
SCALE: 1"=30'

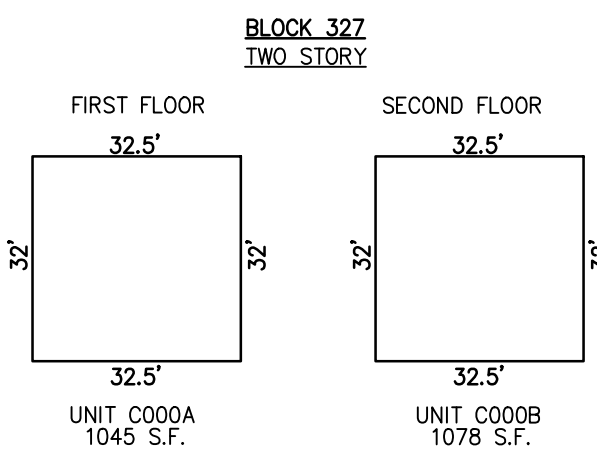

UNIT NO.	LOT NO.
C-000A	C-01
C-000B	C-02

"THIS TAX MAP PLATE HAS BEEN DIGITALLY DRAWN USING COMPUTER-AIDED DRAFTING/DESIGN (CADD) & COORDINATE GEOMETRY (COCO). IT IS BASED ON THE ORIGINAL DIGITALLY DRAWN TAX MAP PLATE BEARING THE OFFICIAL NEW JERSEY DIVISION TAXATION APPROVAL STAMP WITH APPROVAL DATE 6-3-2005 SERIAL NUMBER 846 AND SIGNATURES OF SIGNERS' THOMAS J. REILLY, CHIEF, LOCAL PROPERTY, FIELD ASSISTANCE, SANTO C. DIDONATO, SUPERVISING FIELD REPRESENTATIVE. THE ORIGINAL DIGITALLY DRAWN TAX MAP PLATE WITH THE OFFICIAL APPROVAL STAMP IS ON FILE WITH REMINGTON, VERNICK & WALBERG ENGINEERS."

CONDOMINIUM DETAILS AND DIMENSIONS

BLOCK 230, LOT 40
BLOCK 230, LOT 318
BLOCK 231, LOT 6
BLOCK 324.01, LOT 7
BLOCK 327, LOT 101
SEE PLATE 5

TAX MAP
CITY OF MARGATE

ATLANTIC COUNTY NEW JERSEY
SCALE: AS NOTED DATE: 1-30-2004

CRAIG F. REMINGTON LAND SURVEYOR LIC. NO. 23924



REMINGTON, VERNICK & WALBERG ENGINEERS
845 N. MAIN STREET, PLEASANTVILLE, NJ 08232
(609) 645-710, FAX (609) 645-7076
WEB SITE ADDRESS: WWW.RVW.COM